

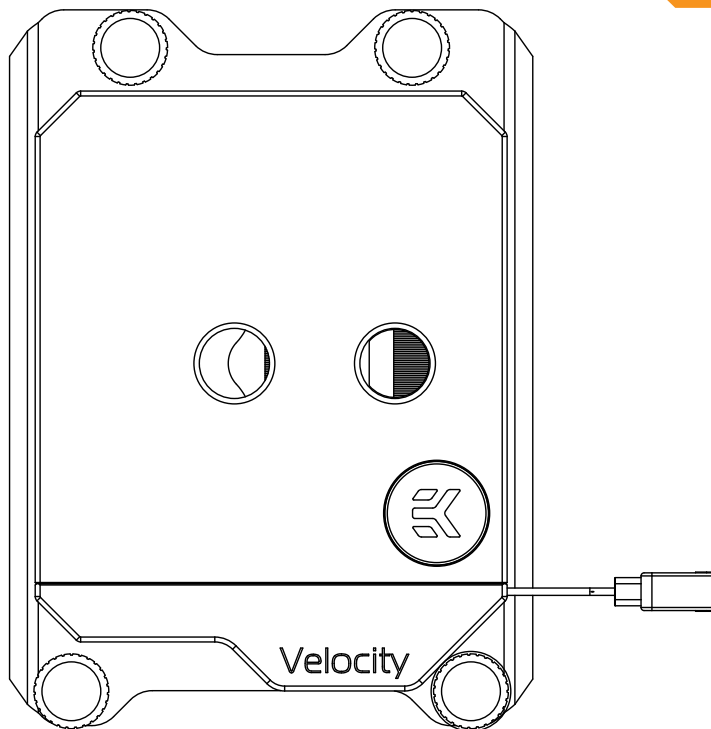

EK-Velocity sTR4

CPU WATER BLOCK



This product is intended for installation only by expert users. Please consult with a qualified technician for installation. Improper installation may result in damage to your equipment. EK Water Blocks assumes no liability whatsoever, expressed or implied, for the use of these products, nor their installation. The following instructions are subject to change without notice. Please visit our web site at www.ekwb.com for updates. Before installation of this product please read important notice, disclosure and warranty conditions printed on the back of the box.

Before you start using this product please follow these basic guidelines:

Please carefully read the manual before beginning with the installation process!

Please remove your graphics card from the computer to assure safest mounting process in order to prevent any possible damages to your GPU and/or graphics card circuit board (PCB).

The EK Fittings require only a small amount of force to screw them firmly in place since the liquid seal is ensured by the rubber O-ring gaskets.

The use of corrosion inhibiting coolants is always recommended for liquid cooling systems, and mandatory for nickel plated water blocks!

Do not use pure distilled water! For best results EK recommends the use of EK-CryoFuel coolants!

Make sure to thoroughly bleed air out of your water block, or you will not reach optimal performance!

TABLE OF CONTENT

GENERAL INFORMATION ON WATER BLOCK COMPATIBILITY.....	4	SUPPORT AND SERVICE.....	9
WHAT IS ENCLOSED.....	5	SOCIAL MEDIA.....	9

QUICK INSTALLATION GUIDE

INSTALLING THE WATER BLOCK.....	5
CONNECTING THE RGB LED STRIP (for full nickel version).....	7
CONNECTING THE RGB LED STRIP.....	7
CONNECTING THE D-RGB MODELS.....	8
CONNECTING THE D-RGB LED STRIP.....	8

GENERAL INFORMATION ON WATER BLOCK COMPATIBILITY

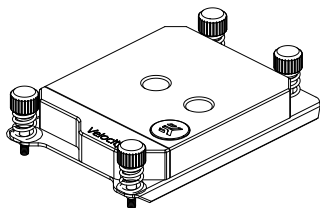

This CPU liquid cooling unit is pre-assembled for use with modern AMD desktop socket type motherboards. By default (out of the box) this water block supports the following CPU sockets:

- **AMD TR4 socket**
- **AMD SP3 socket**

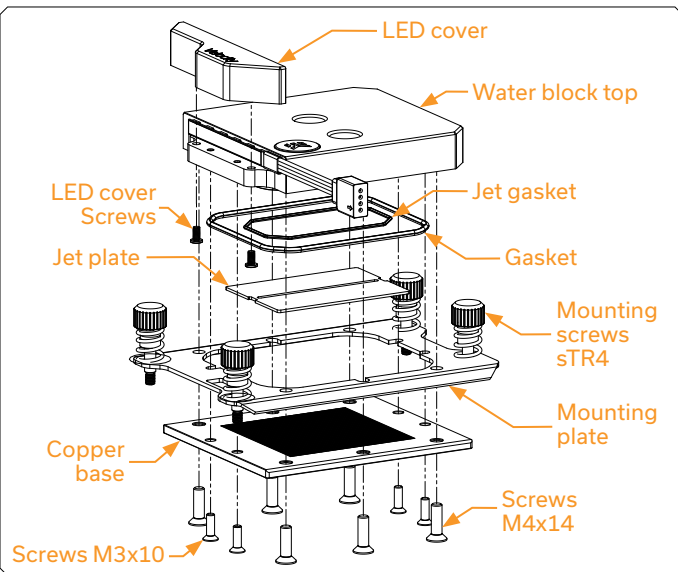

WHAT IS ENCLOSED

The following items are enclosed with each EK-Velocity water block:

- EK-Velocity sTR4 CPU water block
- Allen (hex) key 2.5mm
- Allen (hex) key 2mm
- EK-TIM Ectotherm 1g

INSTALLING THE WATER BLOCK

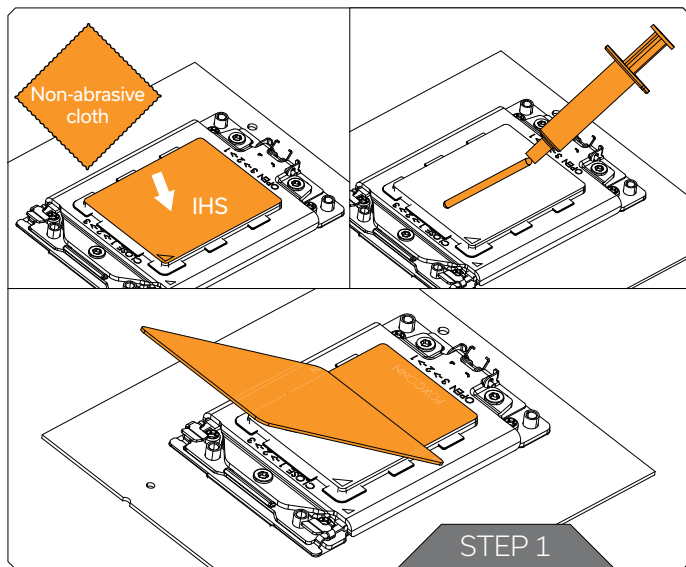

STEP 1

Cleaning the CPU: Wipe the CPU's contact surface (by using non-abrasive cloth or Q-tip, as shown on sample photo).

Applying thermal compound: EK recommends blob or line method of applying the enclosed EK-TIM Ectotherm (1g) thermal compound to the CPU heatspreader (IHS)

Applying thermal compound: On a clean IHS, apply a line of thermal compound and spread it over the whole CPU heat spreader (IHS) with a credit card or equivalent - see sample photo on left

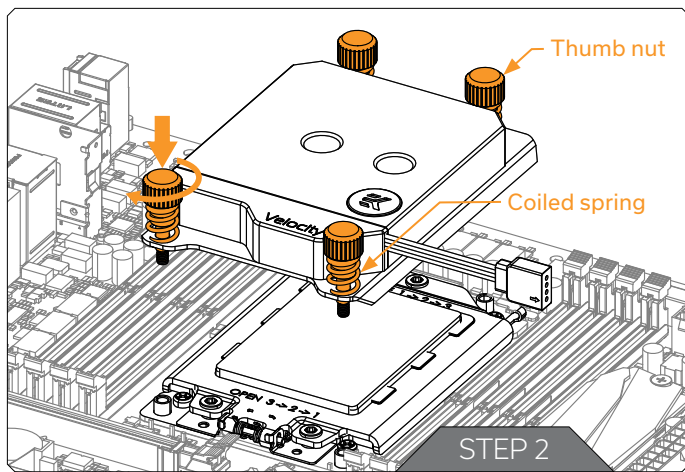

STEP 2

Align the water block over the mounting screws.



Before proceeding with the installation It is mandatory to remove the protective foil from the backside of the water block.

Place an enclosed compression spring and thumb nut over each M3,5 thumb screw. Start fastening two thumb nuts at a time, preferably in cross pattern and do not tighten them fully until all of them are partially screwed in. Then - using your fingers only - screw in all four thumb nuts until you reach the end of the thread.

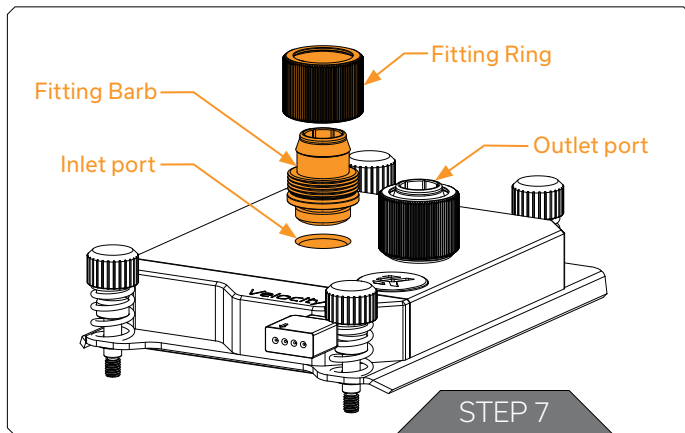

STEP 3

Tighten the fitting barbs in clockwise direction until the gasket underneath is compressed.

The installation of the CPU water block is now complete.



Before proceeding with the installation It is mandatory to remove the protective foil from the backside of the water block.

With EK-Velocity series water blocks it is mandatory to use the port that is nearest to the center of the water block as INLET port. Mixing the ports may result in less than ideal thermal performance of the water block.

CONNECTING THE RGB LED STRIP (for full nickel version)

CONNECTING THE RGB LED STRIP

STEP 1

Plug the 4-pin connector from Water block's and Fan's RGB LED light to the RGB HEADER on the motherboard. The LED will work if the pin layout on the header is as follows: **+12V G R B**.



Please ensure that the arrow indicated on the connector is plugged into the +12V line as indicated on your motherboard.

Failure to do so, will damage your motherboard or LED strip.

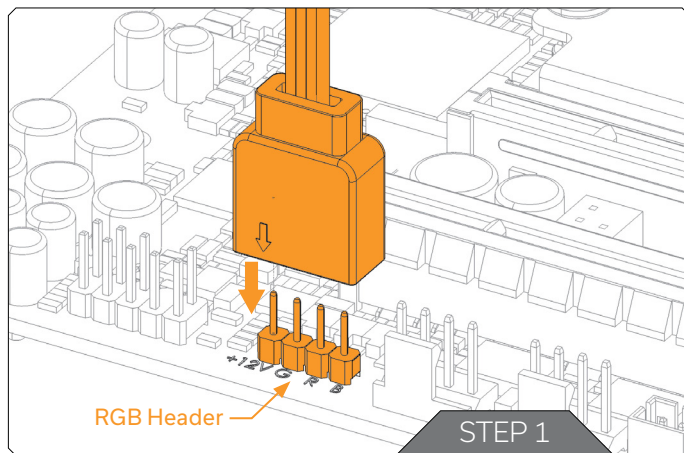
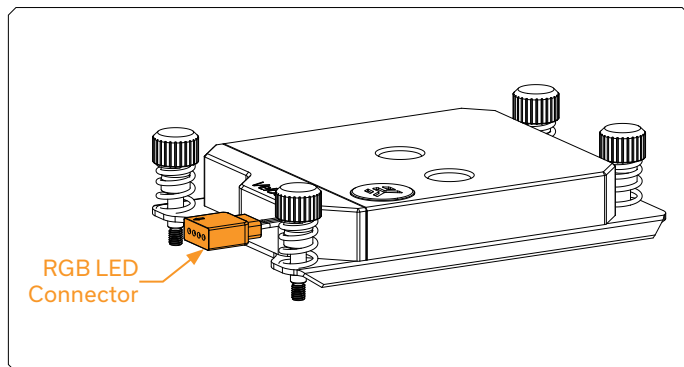

CONNECTING THE D-RGB MODELS

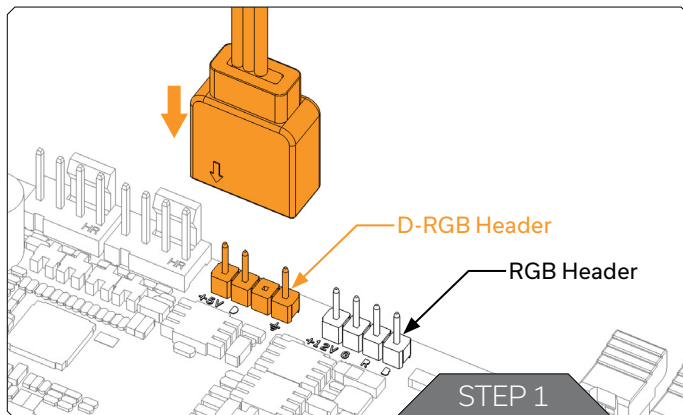

CONNECTING THE D-RGB LED STRIP

STEP 1

Plug the 4-pin connector from Water block's D-RGB LED light to the DRGB HEADER on the motherboard. The LED will work if the pin layout on the header is as follows: **+5V, Digital, empty, Ground**.



Please ensure that the arrow indicated on the connector is plugged into the +5V line as indicated on your motherboard. If you put LED Diode to the 12V RGB HEADER you can damage the LEDs.

Failure to do so will damage your motherboard or LED strip.



Connector is the same on D-RGB and RGB versions, but D-RGB version has 3 cables from connector to PCB; RGB version has 4 cables. If you connect D-RGB led to ordinary RGB header you can damage your motherboard or LED strip.

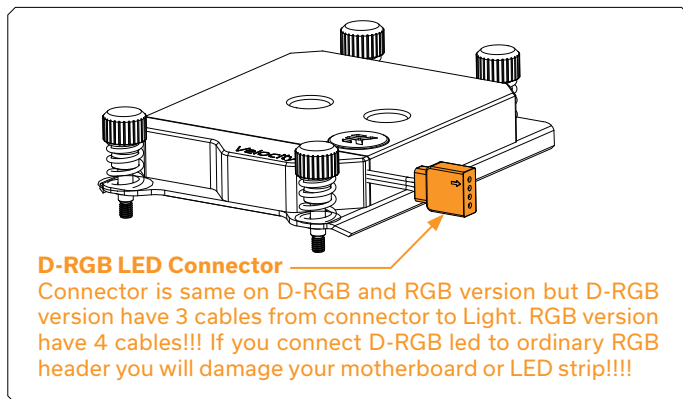

SUPPORT AND SERVICE

For assistance please contact:

<http://support.ekwb.com/>

EKWB d.o.o.
Pod lipami 18
1218 Komenda
Slovenia - EU

SOCIAL MEDIA

 EKWaterBlocks

 @EKWaterBlocks

 ekwaterblocks

 EKWBofficial

 ekwaterblocks

